

**This electronic collection of documents is provided
for the convenience of the user
and is Not a Certified Document –**

**The documents contained herein were originally issued
and sealed by the individuals whose names and license
numbers appear on each page, on the dates appearing
with their signature on that page.**

**This file or an individual page
shall not be considered a certified document.**

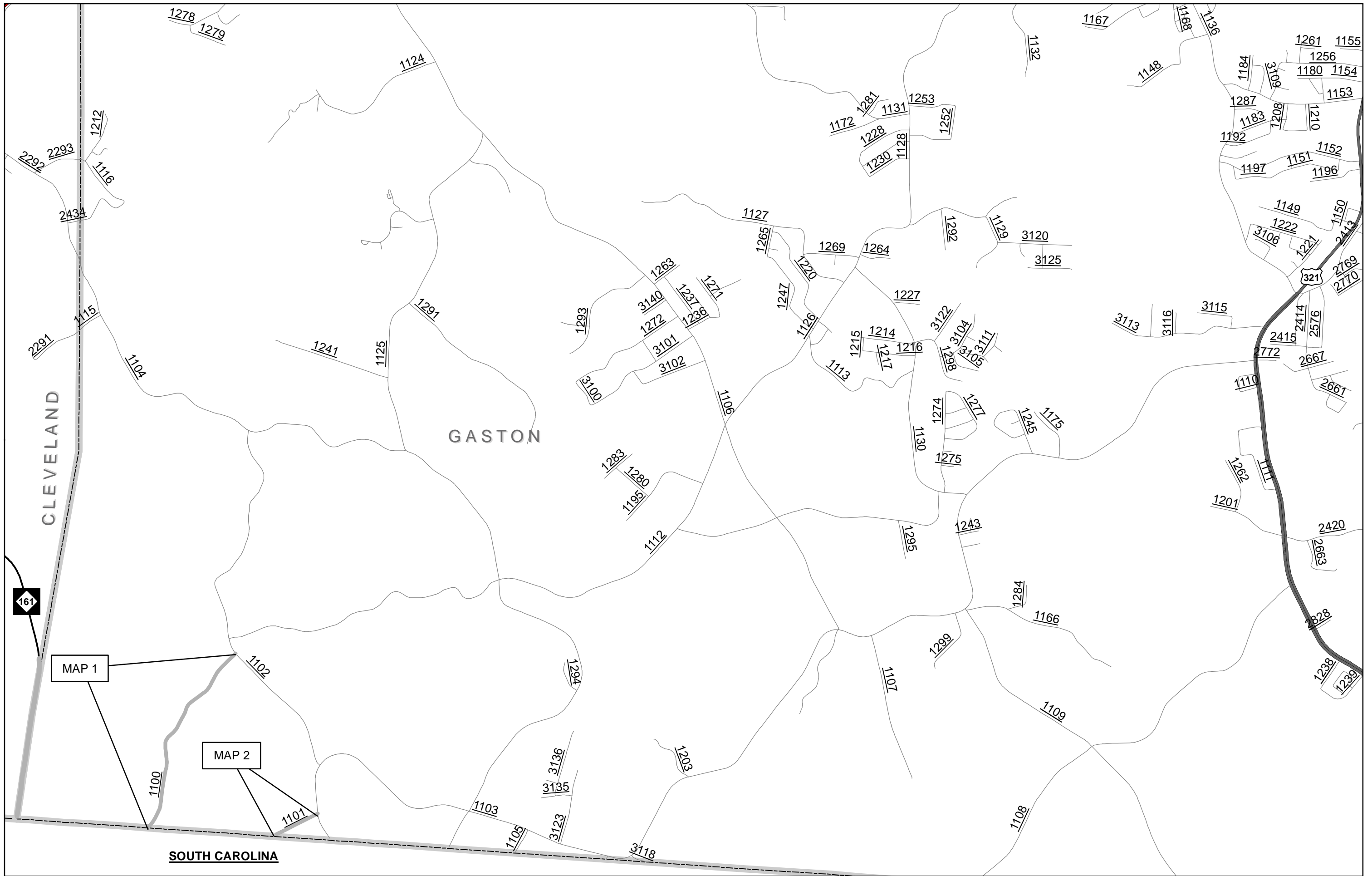

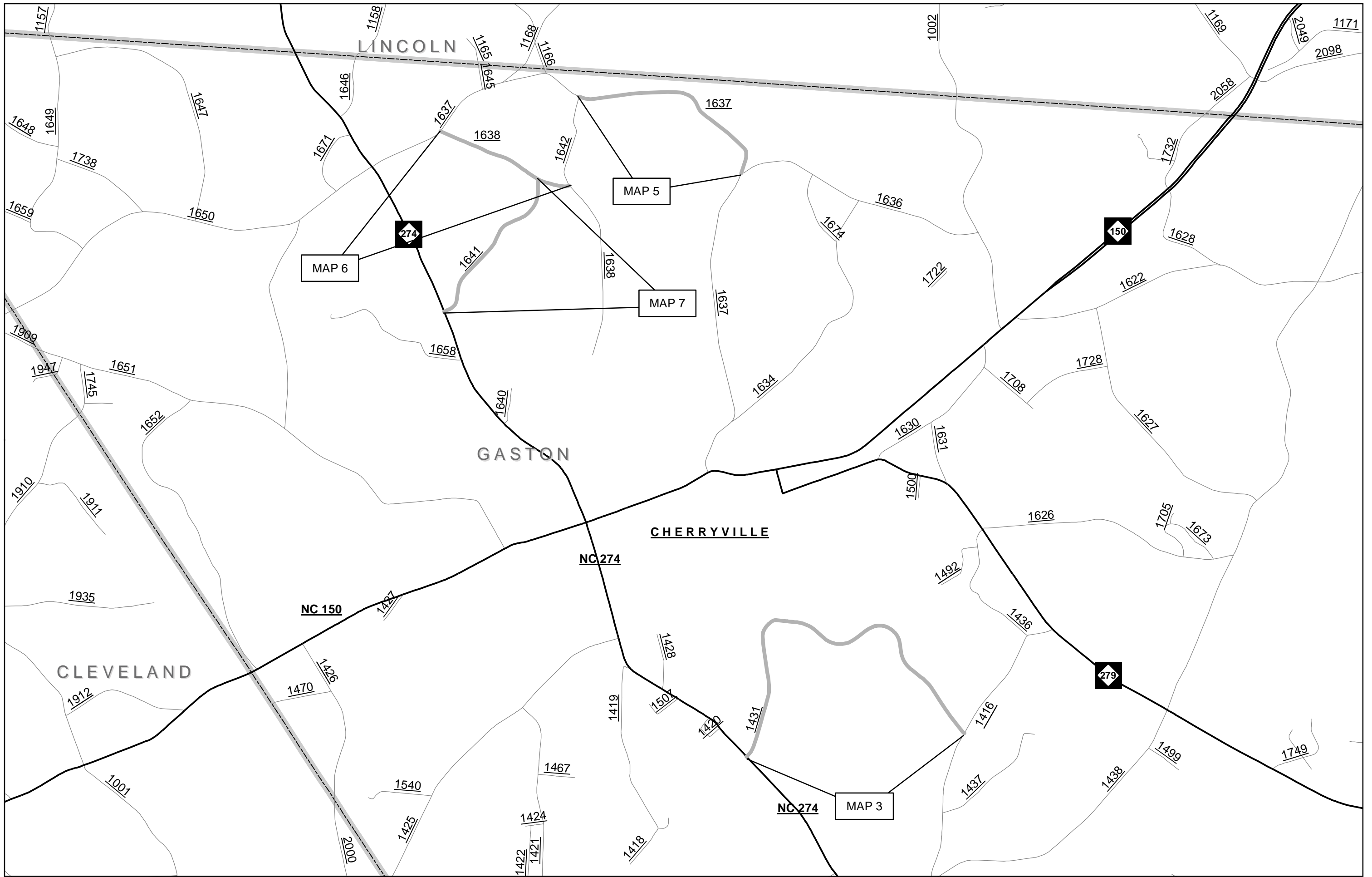

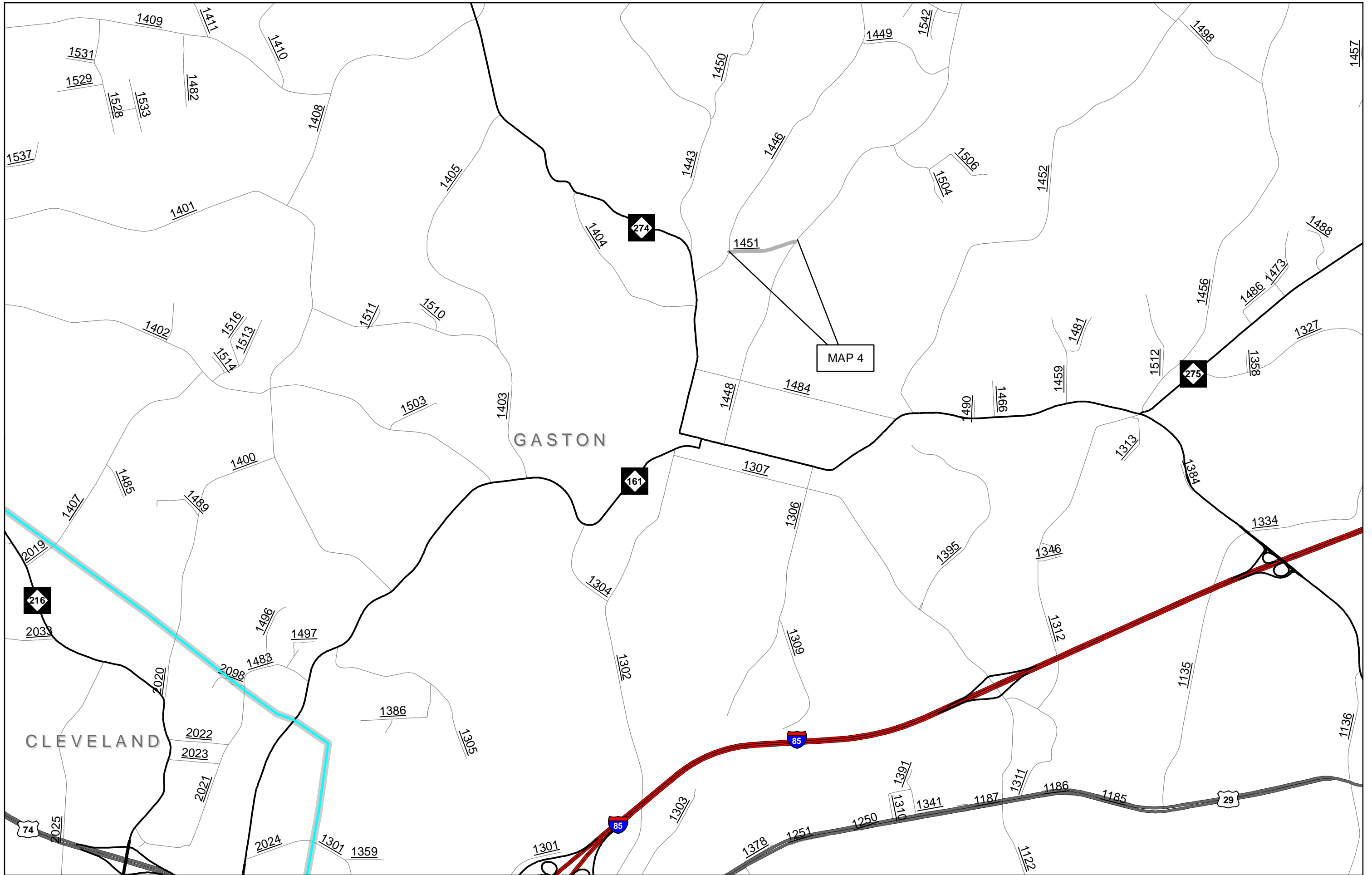

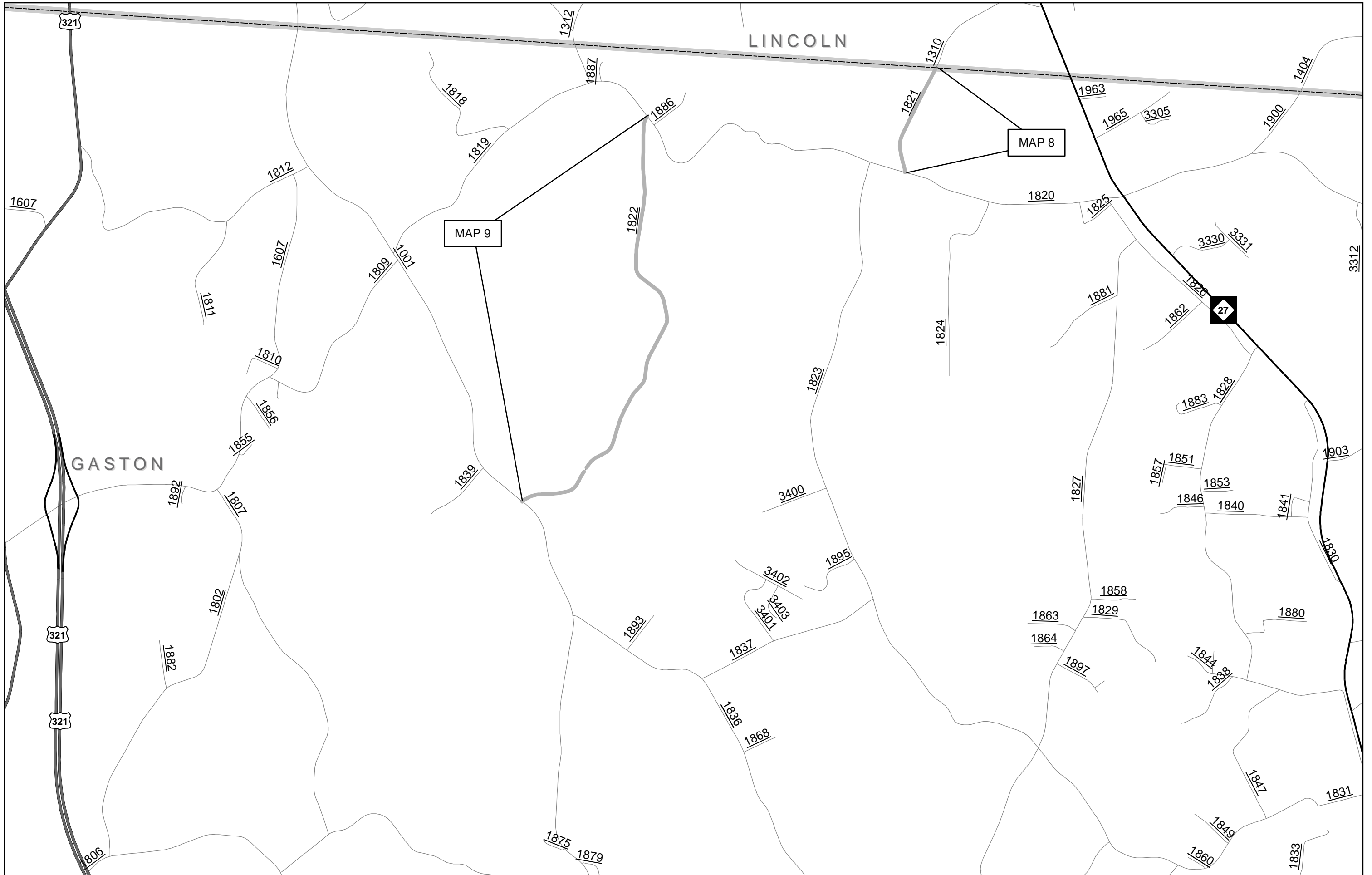

LINCOLN

GASTON

MAP 8

MAP 9

27



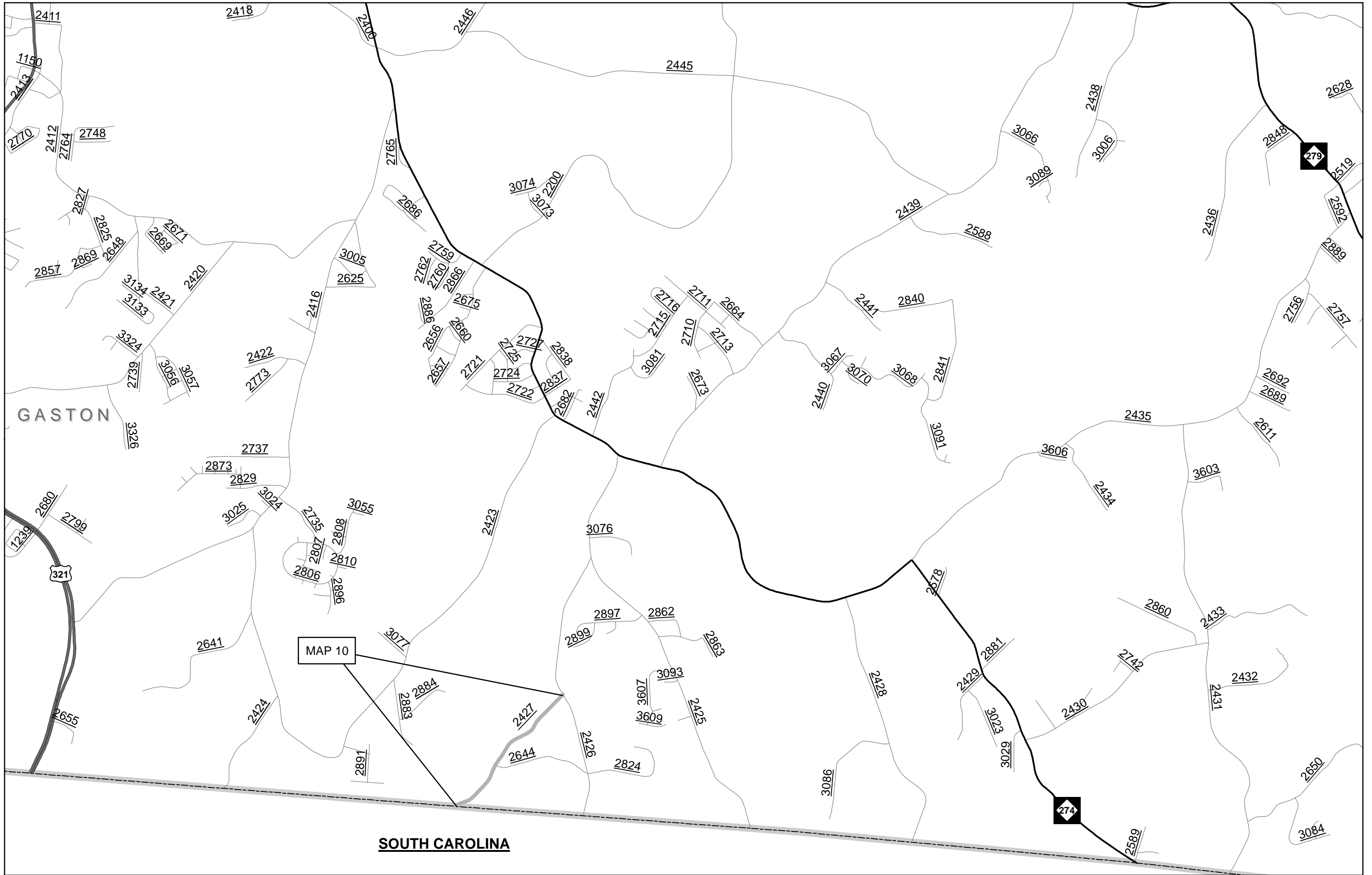

GASTON

MAP 10

SOUTH CAROLINA



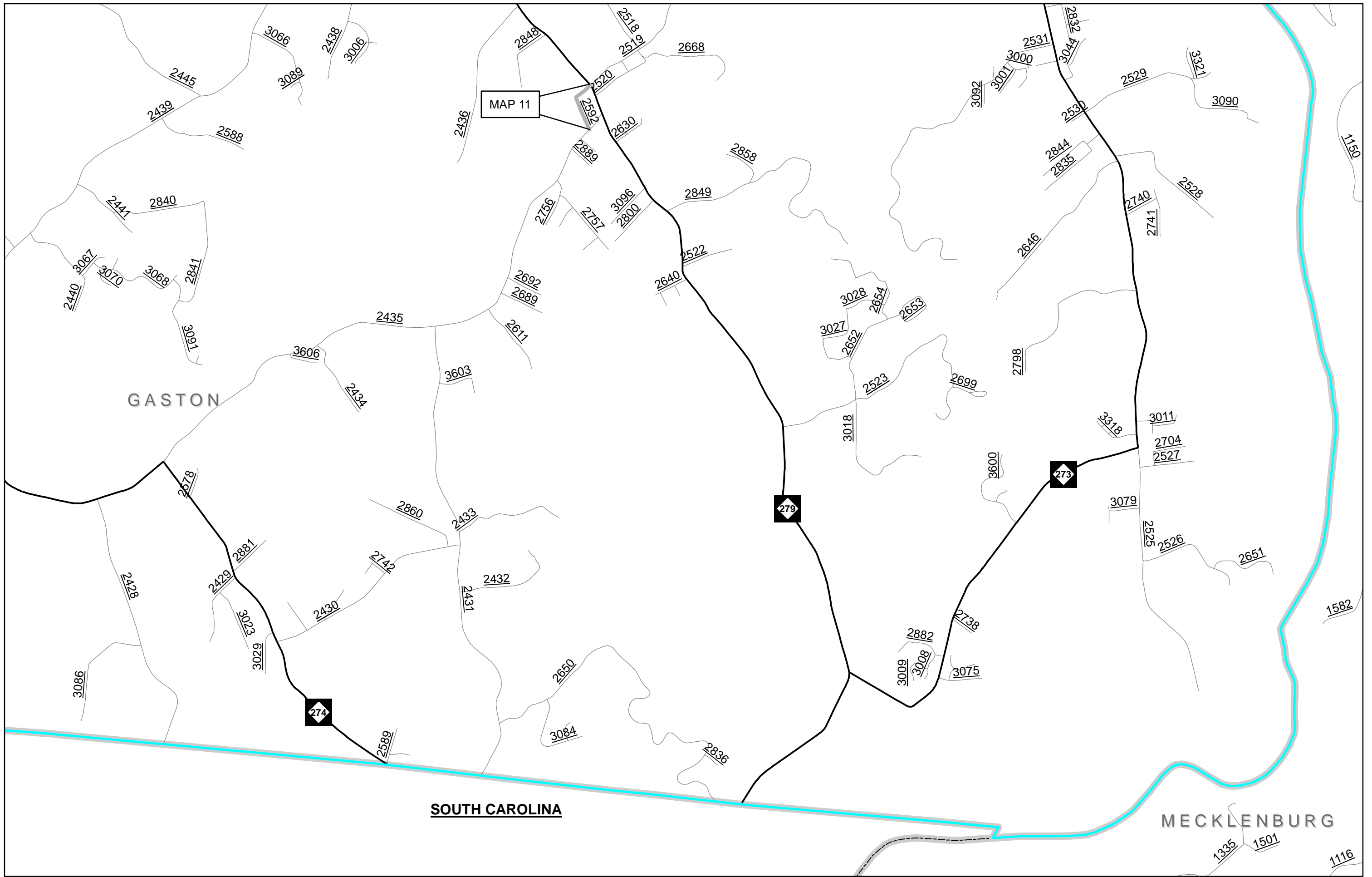

MAP 11

GASTON

SOUTH CAROLINA

MECKLENBURG



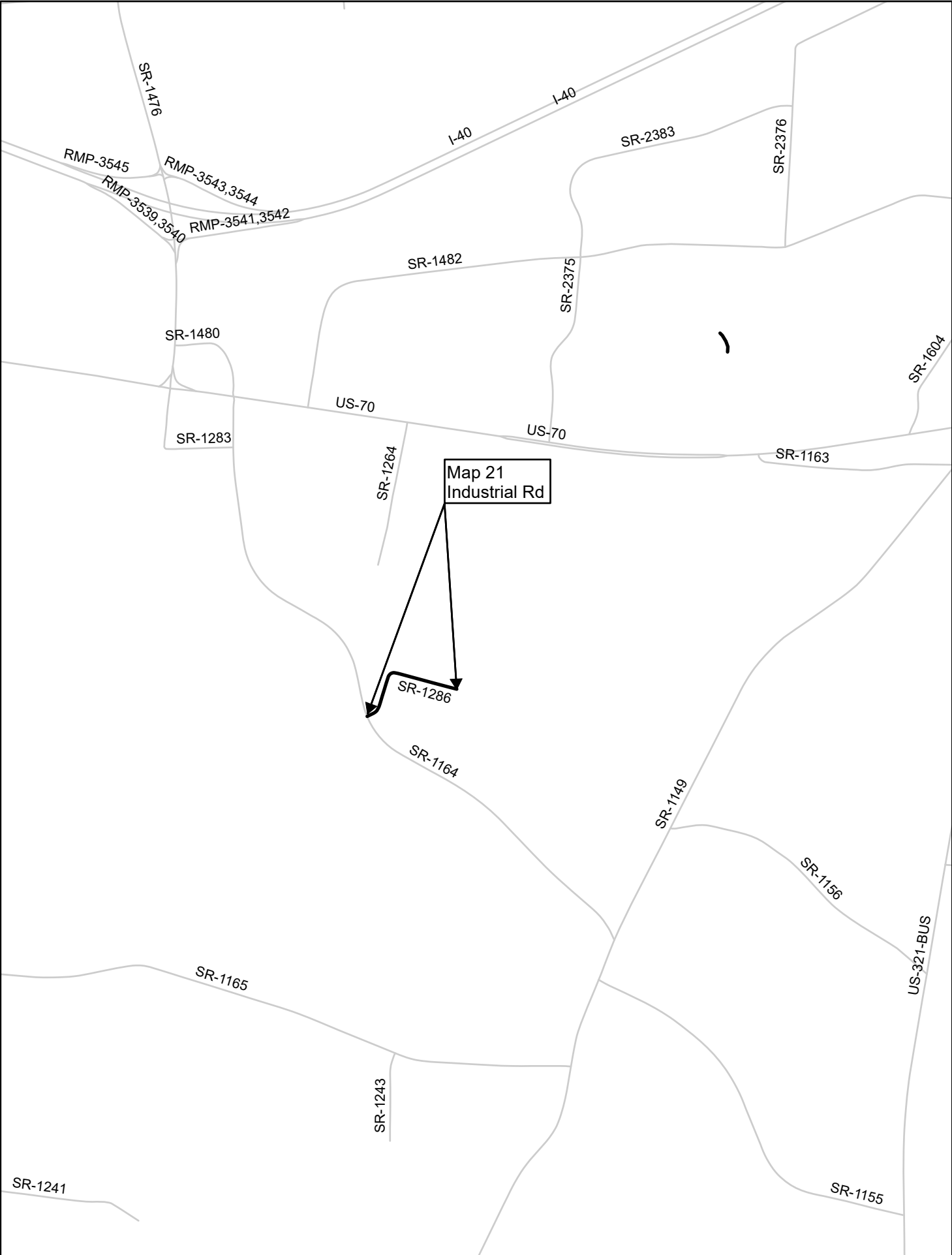

PAVEMENT SCHEDULE	
F	LATEX MODIFIED MICROSURFACING TYPE III AT AN APPLICATION RATE OF 22 TO 26 POUNDS PER SQUARE YARD

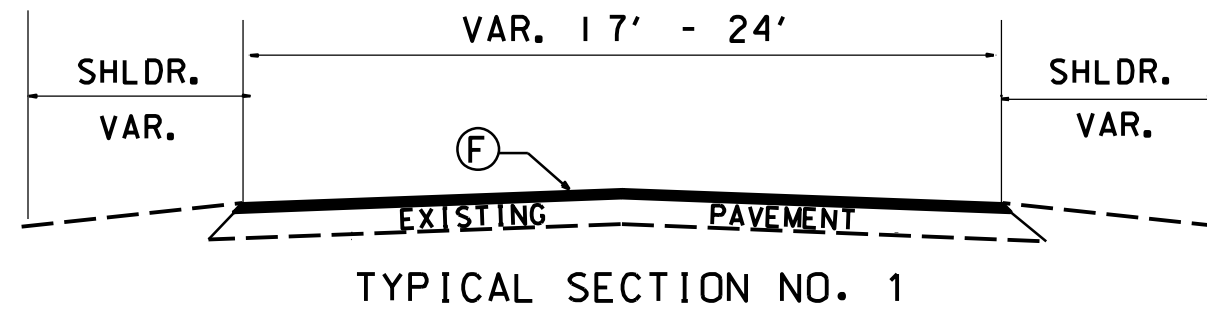

2020-2021
Pavement Preservation
Gaston & Catawba
Counties

PROJECT NO.	SHEET NO.	TOTAL NO.
2020CPT.12.08.20182	11	13
2020CPT.12.08.20362		

SUMMARY OF QUANTITIES

PROJECT NO	COUNTY	MAP NO	ROUTE	DESCRIPTION	TYP NO	LANES	LANE TYPE	FINAL SURFACE TESTING REQUIRED	LENGTH	WIDTH	1220000000-E	1891000000-E	1880000000-E	1882000000-E	
											INCIDENTAL STONE BASE	LATEX MODIFIED MICROSURFACING TYPE III	AGGREGATE, TYPE III	LATEX MODIFIED EMULSION	
											MI	FT	TONS	SY	TON
2020CPT.12.08.20362	Gaston	1	SR 1100 (BATTLEGROUND RD.)	SOUTH CAROLINA TO SR 1102	1	2	2WU	NO	1.1	VAR. 20-21	15	14,552	140	3,056	
2020CPT.12.08.20362	Gaston	2	SR 1101 (WELLS RD.)	SOUTH CAROLINA TO SR 1102	1	2	2WU	NO	0.25	19		3,065			
2020CPT.12.08.20362	Gaston	3	SR 1431 (KENWOOD RD.)	NC 274 TO SR 1416	1	2	2WU	NO	2.2	VAR. 20-24	29	28,537	274	5,993	
2020CPT.12.08.20362	Gaston	4	SR 1451 (M L KISER RD.)	SR 1446 TO SR 1448	1	2	2WU	NO	0.37	VAR. 19-20		4,656			
2020CPT.12.08.20362	Gaston	5	SR 1637 (TOT DELINGER RD.)	SR 1636 TO SR 1642	1	2	2WU	NO	1.17	19	14	14,346	138	3,013	
2020CPT.12.08.20362	Gaston	6	SR 1638 (BLACK RD.)	SR 1644 TO SR 1642	1	2	2WU	NO	0.77	18	9	8,944	86	1,878	
2020CPT.12.08.20362	Gaston	7	SR 1641 (LEE BLACK RD.)	NC 274 TO SR 1638	1	2	2WU	NO	0.94	18	11	10,919	105	2,293	
2020CPT.12.08.20362	Gaston	8	SR 1821 (HIPPO RD.)	SR 1820 TO LINCOLN COUNTY	1	2	2WU	NO	0.53	VAR. 17-18	6	5,985	57	1,257	
2020CPT.12.08.20362	Gaston	9	SR 1822 (NARROW GAUGE RD.)	SR 1001 TO SR 1820	1	2	2WU	NO	2.12	VAR. 19-20	27	26,678	256	5,602	
2020CPT.12.08.20362	Gaston	10	SR 2427 (RIDDLE RD.)	SR 2426 TO SOUTH CAROLINA	1	2	2WU	NO	0.86	20	9	11,100	107	2,331	
2020CPT.12.08.20362	Gaston	11	SR 2592 (TWIN-TOPPS RD.)	NC 279 TO SR 2435	1	2	2WU	NO	0.29	20	4	3,743	36	786	
TOTAL FOR PROJ NO. 2020CPT.12.08.20362											10.60	124	132,525	1,199	26,209
2020CPT.12.08.20182	Catawba	12	SR 1817 (JOE JOHNSON RD)	FROM SR 1833 (LONG ISLAND RD) TO BRIDGE 158		2	2WU	NO	2.16	18	10	23,950			
2020CPT.12.08.20182	Catawba	13	SR 1819 (BROWN CHAPEL RD)	FROM SR 1004 (HUDSON CHAPEL RD) TO SR 1833 (LONG ISLAND RD)		2	2WU	NO	1.66	18	10	18,406			
2020CPT.12.08.20182	Catawba	14	SR 1822 (LOWRANCE RD)	FROM SR 1826 (HUDSON CHAPEL RD) TO SR 1848 (SHERRILLS FORD RD)		2	2WU	NO	2.74	19	10	32,069			
2020CPT.12.08.20182	Catawba	15	SR 1700 (RIVER BEND RD)	FROM SR 1703 (SHELL HOLLAR RD) TO SR 1704 (RIVERBEND RD)		2	2WU	NO	2.53	18	10	26,717			
2020CPT.12.08.20182	Catawba	16	SR 1704 (RIVER BEND RD)	FROM SR 1700 (RIVER BEND RD) TO SR 1006 (OXFORD SCHOOL RD)		2	2WU	NO	0.63	18	5	6,653			
2020CPT.12.08.20182	Catawba	17	SR 1702 (REST HOME RD)	FROM SR 1700 (RIVERBEND RD) TO SR 1703 (SHELL HOLLAR RD)		2	2WU	NO	1.18	18	10	13,084			
2020CPT.12.08.20182	Catawba	18	SR 1710 (COMMUNITY RD)	FROM SR 1709 (SHOOK RD) TO SR 1711 (ROCK BARN RD)		2	2WU	NO	1.41	18	10	15,634			
2020CPT.12.08.20182	Catawba	19	SR 1708 (HALL DAIRY RD)	FROM SR 1709 (ROCK BARN RD) TO SR 1709 (ROCK BARN RD)		2	2WU	NO	1.41	18	5	15,634			
2020CPT.12.08.20182	Catawba	20	SR 1515 (SWINGING BRIDGE)	FROM SR 1517 (SPRINGS RD) TO NC 16		2	2WU	NO	2.69	18	10	29,827			
2020CPT.12.08.20182	Catawba	21	SR 1286 (INDUSTRIAL DR)	FROM SR 1164 (ST PAULS CH RD) TO DEAD END		2	2WU	NO	0.28	20	5	3,450			
TOTAL FOR PROJ NO. 2020CPT.12.08.20182											16.69	85	185,424		
GRAND TOTAL											27.29	209	317,949	1,199	26,209

PROJECT NO.	SHEET NO.	TOTAL NO.
2020CPT.12.08.20182	12	13
2020CPT.12.08.20362		

THERMOPLASTIC AND PAINT QUANTITIES

PROJECT NO	COUNTY	MAP NO	ROUTE	DESCRIPTION	TYP NO	LANES	LANE TYPE	LENGTH	WIDTH	4413000000-E	4457000000-N	4720000000-E	4810000000-E	4810000000-E	4875000000-N	4870000000-E	4891000000-E	
								MI	FT	WORK ZONE ADVANCE/GENERAL WARNING SIGNING	TEMPORARY TRAFFIC CONTROL	THERMO MSG SCHOOL 90 M	4" WHITE PAINT	4" YELLOW PAINT	REMOVAL OF PAVEMENT MARKING SYMBOLS & CHARACTERS	24" LINE REMOVAL	24" x 90 M WHITE THERMO	
								EA	EA	EA	EA	EA	EA	EA	EA	EA		
2020CPT.12.08.20362	Gaston	1	SR 1100 (BATTLEGROUND RD.)	SOUTH CAROLINA TO SR 1102	1	2	2WU	1.1	VAR. 20-21	116								
2020CPT.12.08.20362	Gaston	2	SR 1101 (WELLS RD.)	SOUTH CAROLINA TO SR 1102	1	2	2WU	0.25	19	84								
2020CPT.12.08.20362	Gaston	3	SR 1431 (KENWOOD RD.)	NC 274 TO SR 1416	1	2	2WU	2.2	VAR. 20-24	148								
2020CPT.12.08.20362	Gaston	4	SR 1451 (M L KISER RD.)	SR 1446 TO SR 1448	1	2	2WU	0.37	VAR. 19-20	84								
2020CPT.12.08.20362	Gaston	5	SR 1637 (TOT DELINGER RD.)	SR 1636 TO SR 1642	1	2	2WU	1.17	19	116								
2020CPT.12.08.20362	Gaston	6	SR 1638 (BLACK RD.)	SR 1644 TO SR 1642	1	2	2WU	0.77	18	84								
2020CPT.12.08.20362	Gaston	7	SR 1641 (LEE BLACK RD.)	NC 274 TO SR 1638	1	2	2WU	0.94	18	84								
2020CPT.12.08.20362	Gaston	8	SR 1821 (HIPPO RD.)	SR 1820 TO LINCOLN COUNTY	1	2	2WU	0.53	VAR. 17-18	84								
2020CPT.12.08.20362	Gaston	9	SR 1822 (NARROW GAUGE RD.)	SR 1001 TO SR 1820	1	2	2WU	2.12	VAR. 19-20	148								
2020CPT.12.08.20362	Gaston	10	SR 2427 (RIDDLE RD.)	SR 2426 TO SOUTH CAROLINA	1	2	2WU	0.86	20	84								
2020CPT.12.08.20362	Gaston	11	SR 2592 (TWIN-TOPPS RD.)	NC 279 TO SR 2435	1	2	2WU	0.29	20	84						30	30	
TOTAL FOR PROJ NO. 2020CPT.12.08.20362								10.6		1,116	*		228,111	228,111			30	30
2020CPT.12.08.20182	Catawba	12	SR 1817 (JOE JOHNSON RD)	FROM SR 1833 (LONG ISLAND RD) TO BRIDGE 158		2	2WU	2.16	18	150								
2020CPT.12.08.20182	Catawba	13	SR 1819 (BROWN CHAPEL RD)	FROM SR 1004 (HUDSON CHAPEL RD) TO SR 1833 (LONG ISLAND RD)		2	2WU	1.66	18	150								
2020CPT.12.08.20182	Catawba	14	SR 1822 (LOWRANCE RD)	FROM SR 1826 (HUDSON CHAPEL RD) TO SR 1848 (SHERRILLS FORD RD)		2	2WU	2.74	19	175		6			6	38	38	
2020CPT.12.08.20182	Catawba	15	SR 1700 (RIVER BEND RD)	FROM SR 1703 (SHELL HOLLAR RD) TO SR 1704 (RIVERBEND RD)		2	2WU	2.53	18	215								
2020CPT.12.08.20182	Catawba	16	SR 1704 (RIVER BEND RD)	FROM SR 1700 (RIVER BEND RD) TO SR 1006 (OXFORD SCHOOL RD)		2	2WU	0.63	18	125								
2020CPT.12.08.20182	Catawba	17	SR 1702 (REST HOME RD)	FROM SR 1700 (RIVERBEND RD) TO SR 1703 (SHELL HOLLAR RD)		2	2WU	1.18	18	145								
2020CPT.12.08.20182	Catawba	18	SR 1710 (COMMUNITY RD)	FROM SR 1709 (SHOOK RD) TO SR 1711 (ROCK BARN RD)		2	2WU	1.41	18	75								
2020CPT.12.08.20182	Catawba	19	SR 1708 (HALL DAIRY RD)	FROM SR 1709 (ROCK BARN RD) TO SR 1709 (ROCK BARN RD)		2	2WU	1.41	18	50								
2020CPT.12.08.20182	Catawba	20	SR 1515 (SWINGING BRIDGE)	FROM SR 1517 (SPRINGS RD) TO NC 16		2	2WU	2.69	18	150								
2020CPT.12.08.20182	Catawba	21	SR 1286 (INDUSTRIAL DR)	FROM SR 1164 (ST PAULS CH RD) TO DEAD END		2	2WU	0.28	20	50								
TOTAL FOR PROJ NO. 2020CPT.12.08.20182								16.69		1,285	*	6	352,510	352,510	6	38	38	
GRAND TOTAL								27.29		2,401	1	6	580,621	580,621	6	68	68	

SIGNING FOR ASPHALT SURFACE TREATMENT

LEGEND

- ▷ PORTABLE SIGN
- └ STATIONARY SIGN
- ← DIRECTION OF TRAFFIC FLOW

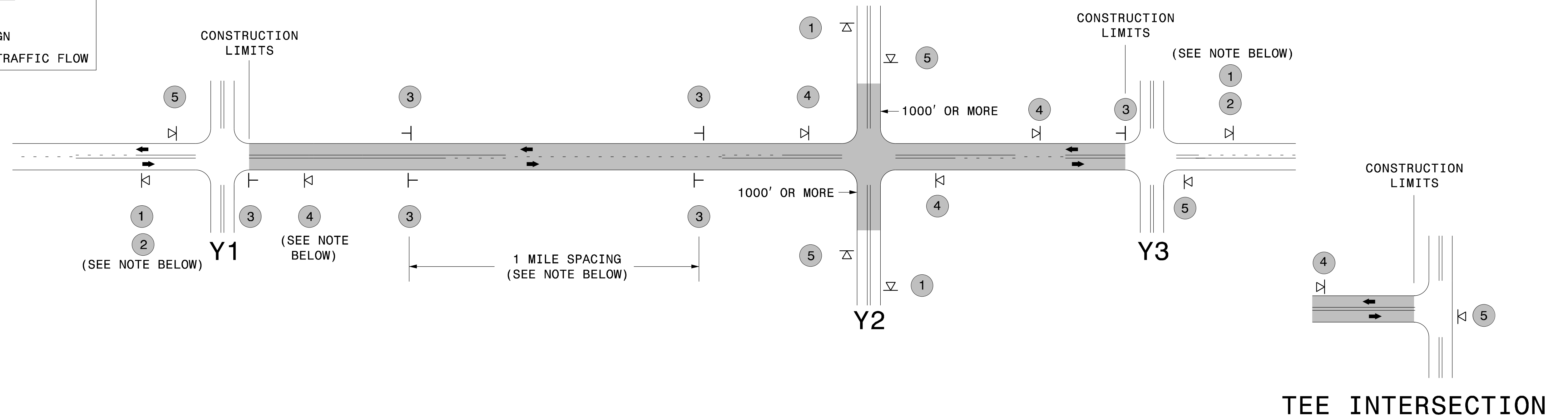

MAINLINE (-L-) SIGNING

-Y- LINE SIGNING

SIGNING NOTES AND PLACEMENT PER DIRECTION	1	 W20-1 48" X 48"	- PLACE 1000' PRIOR TO BEGINNING OF CONSTRUCTION LIMITS. ONLY USED ON -Y- LINES IF RESURFACING LIMITS EXTEND 1000' ALONG -Y- LINE.	<p>STATIONARY SIGNING NOT REQUIRED FOR THE FOLLOWING -Y- LINE CONDITIONS:</p> <ol style="list-style-type: none"> 1) LESS THAN 1000' OF RESURFACING ALONG -Y- LINE 2) SUBDIVISION ROADS 3) DEAD END ROADS <p>WHEN PAVING/CONSTRUCTION ACTIVITIES PROCEED ACROSS AN UNSIGNED -Y- LINE, PORTABLE ADVANCE WARNING SIGNS SHALL BE USED ALONG THE -Y- LINE AS SHOWN BELOW. REMOVE UPON COMPLETION OF WORK.</p> <div style="display: flex; justify-content: space-around;"> <div style="text-align: center;"> W20-1 48" X 48" </div> <div style="text-align: center;"> W20-7 A 48" X 48" </div> </div> <p>PLACED 500' IN ADVANCE OF FLAGGER. PLACED 250' IN ADVANCE OF FLAGGER.</p>
	2	 W7-3qP 24" X 18"	- SIGN #2 ONLY USED WHEN RESURFACING LIMITS ARE 2 OR MORE MILES IN LENGTH. ROUND UP TO THE NEAREST WHOLE NUMBER. DO NOT USE FRACTIONAL OR DECIMAL NUMBERS.	
	3	 W8-7 48" X 48"	- ALTERNATE THE FOLLOWING TWO SIGNS: - STARTING WITH "LOOSE GRAVEL" (W8-7) FOLLOWED BY "UNMARKED PAVEMENT". - PLACE INITIALLY AT THE CONSTRUCTION LIMITS AND SPACED 1 MILE APART THEREAFTER.	
		 SP 48" X 48"	- AT TEE INTERSECTIONS INSTALL INITIALLY 0.5 MILE FROM INTERSECTION AND SPACE 1 MILE APART THEREAFTER.	
	4	 SP 13106 48" X 48"	- THESE ARE FOR -Y- LINES THAT ARE "THROUGH" ROADWAYS. DEAD END AND SUBDIVISION ROADS ARE NOT "THROUGH" ROADWAYS. - INSTALL 500' +/- FROM EACH -Y- LINE APPROACH AS SHOWN ABOVE. - FOR MULTIPLE -Y- LINES THAT ARE SEPARATED BY 0.25 MILES OR LESS, TREAT AS A SINGLE UNIT AND INSTALL WITHIN 500' OF EACH APPROACH. - A MAXIMUM OF 2 SIGN SETS PER MILE. DO NOT INSTALL WHEN -Y- LINES ARE WITHIN 0.5 MILES FROM "END ROAD WORK" SIGN.	
5	 G20-2 A 48" X 24"	PLACE 500' FOLLOWING THE END OF CONSTRUCTION LIMITS OR AS SHOWN WHEN WORK ENDS AT A 3-WAY TEE INTERSECTION.		

THE ABOVE SIGNS ARE ALL THAT ARE REQUIRED FOR A CONTRACTOR TO BEGIN A RESURFACING CONTRACT. ANY ADDITIONAL SIGNS REQUESTED BY NCDOT DIVISIONS SHALL BE INSTALLED WITHIN 7 BUSINESS DAYS OF THE START OF CONTRACT WORK.

MAPS LESS THAN 2 MILES

FOR AST RESURFACING MAPS WITH CONSTRUCTION LIMITS LESS THAN 2 MILES IN LENGTH, USE A STATIONARY "LOOSE GRAVEL" SIGN AT THE BEGINNING CONSTRUCTION LIMIT FOLLOWED BY AN "UNMARKED PAVEMENT" SIGN MIDWAY THROUGH AND AN "END ROAD WORK" SIGN AT THE END CONSTRUCTION LIMIT.

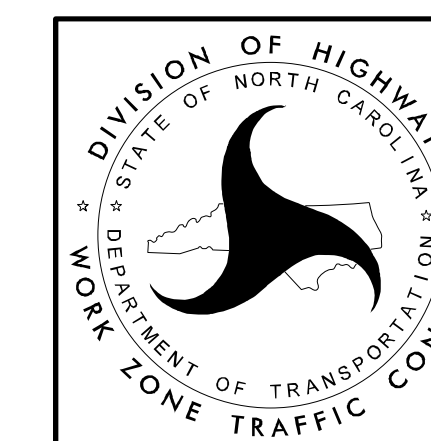

ADVANCE WARNING SIGNS FOR 2-LANE ROADWAY ASPHALT SURFACE TREATMENT